

OPUS VERTICAL



OPUS HORIZONTAL

## OPUS

OPUS is a contemporary round tube radiator. It has a simple, yet sleek design that blends effortlessly into its surrounding. It is a stylish and functional radiator, with high heat outputs, and comes in a range of sizes and models. Standard colour is an attractive white (RAL 9016) but other colour options are available, see page 252.

- OPUS is available in eight different sizes
- Widths range from 324mm - 1000mm
- Heights vary from 468mm - 2000mm



# OPUS

## GENERAL SPECIFICATION & TECHNICAL INFORMATION

- CERTIFICATION**  
Manufactured and tested to BS EN 442. Carries the BS Kitemark. Produced under a quality management system - ISO 9001:2008 and environmental management system - ISO 14001:2004.
- GUARANTEE**  
10 year guarantee from date of purchase against manufacturing defects.
- COLOUR**  
Standard stocked finish is white (RAL 9016). For other special colour options please see page 252.
- MATERIAL**  
Manufactured from steel.
- SYSTEM**  
2 pipe pumped indirect domestic and commercial heating applications.

- CONNECTIONS**  
Vertical: 6 x 1/2" BSP. Horizontal: 4 x 1/2" BSP.
- AIR VENTS**  
Included in the packaging.
- OPERATING PRESSURES**  
Tested to a pressure of 13 bar. Working pressure of up to 10 bar.
- OPERATING TEMPERATURE**  
Maximum 100°C.
- DELIVERY**  
Non-stocked item: 6 - 8 weeks.
- VALVES**  
Please see page 205.

For more general information, please see page 250.

WEIGHTS & WATER CONTENTS PER METRE LENGTH		
Type	Weight (kg)	Water Content (l)
MEZV1	14.49	6.93
MEZV2	20.93	10.01
MEZV3	27.37	13.09
MEZV4	33.81	16.17
MEZH1	7.20	3.32
MEZH2	9.28	4.34
MEZH3	12.01	5.54
MEZH4	15.38	7.24

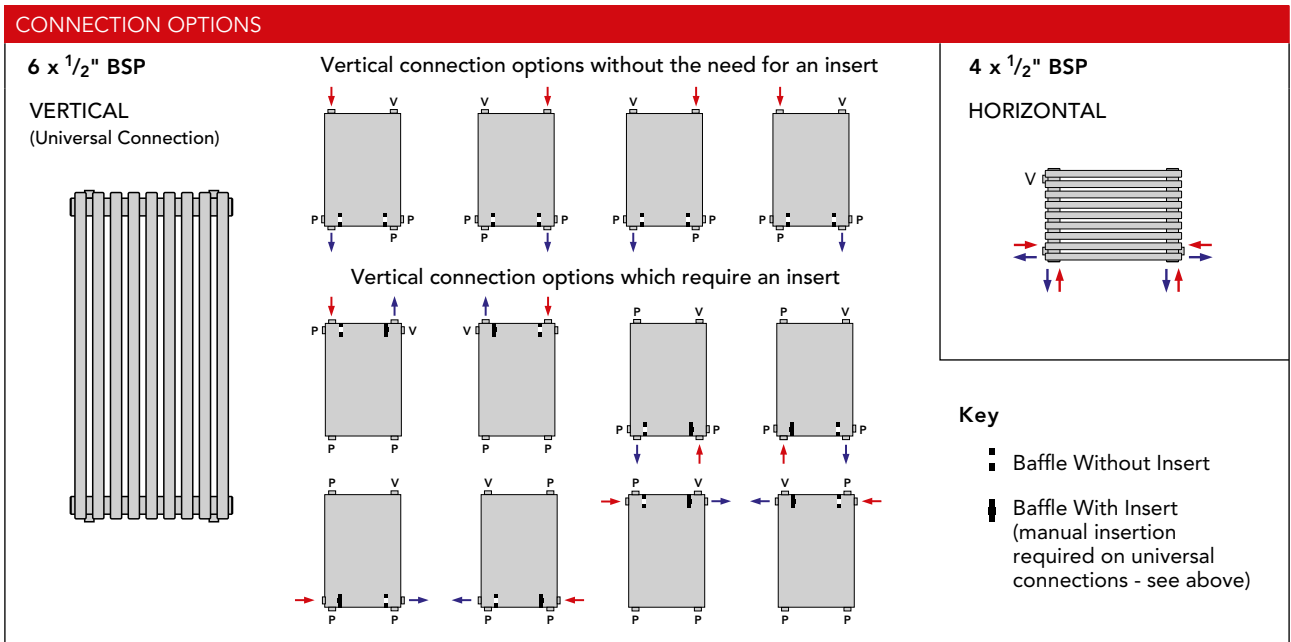
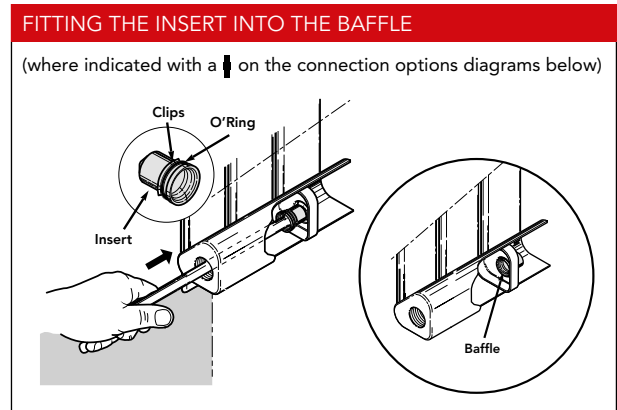

**MOUNTING POSITIONS, DIMENSIONS & WALL BRACKETS**

**OPUS HORIZONTAL**

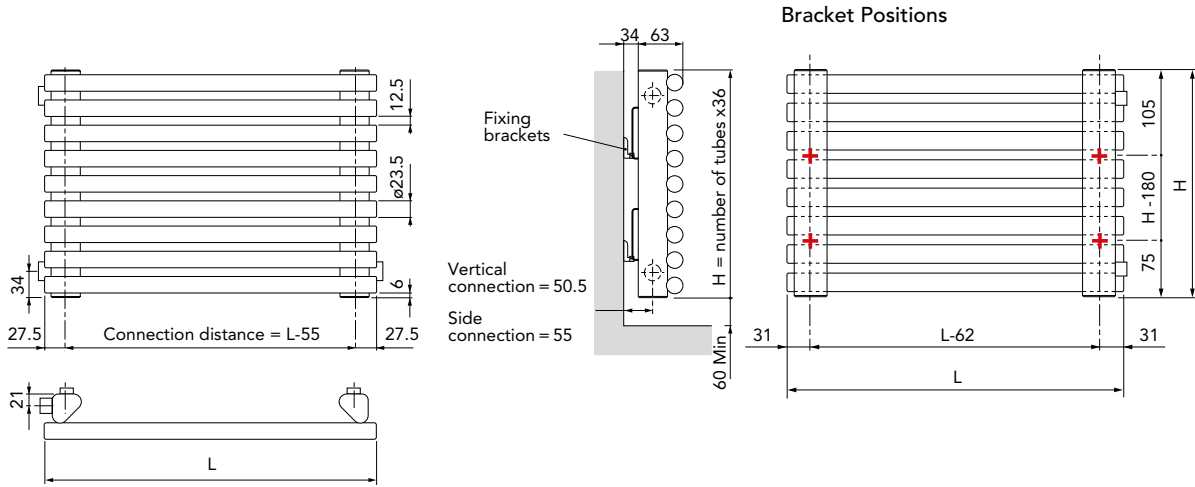

**OPUS VERTICAL**

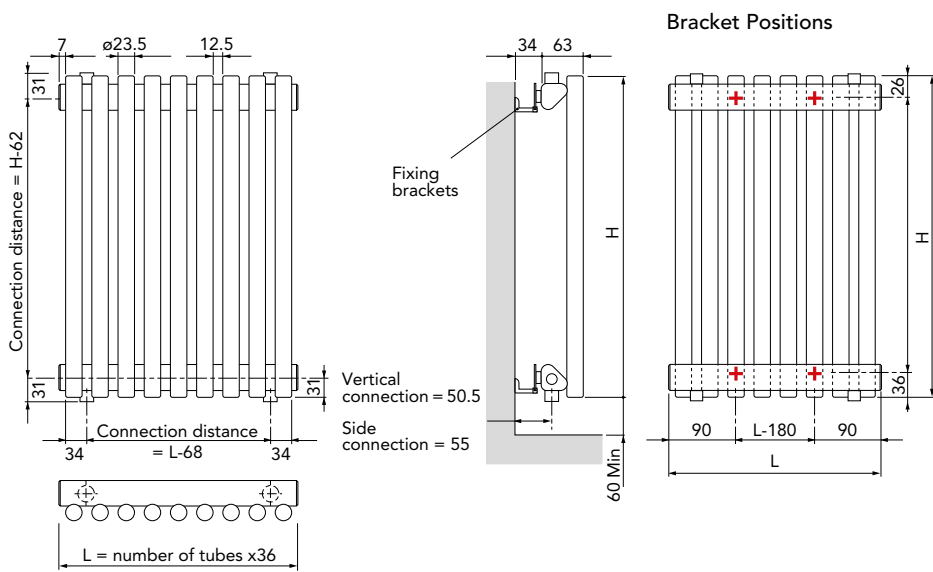

**Wall Bracket Dimensions**

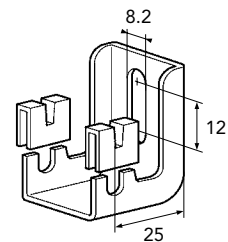

NB: All measurements are nominal.

**HEAT OUTPUTS**

**OPUS VERTICAL**

Order Code	Nominal Height (H) (mm)	Nominal Length (L) (mm)	No. of Tubes	Heat Outputs @ ΔT 50°C		Heat Outputs @ ΔT 30°C		n-coefficients
				Watts	Btu/h	Watts	Btu/h	
MEZV1	2000	324	9	803	2740	413	1409	1.304
MEZV2	2000	468	13	1160	3958	596	2034	1.304
MEZV3	2000	612	17	1516	5173	779	2658	1.304
MEZV4	2000	756	21	1873	6391	1146	3910	1.304

**OPUS HORIZONTAL**

MEZH1	468	600	13	403	1375	212	723	1.258
MEZH2	612	600	17	516	1761	271	925	1.262
MEZH3	468	1000	13	672	2293	353	1204	1.258
MEZH4	612	1000	17	860	2934	451	1539	1.262