



HEATING  
VALVES

DEC15HAC

## DECORATIVE

MYSON offer a selection of DECORATIVE valves for projects that need that extra special finishing touch. Manufactured from solid brass, they are beautifully finished in highly polished chrome. The range includes compression and screwed iron connections, with straight and angle options available.

### GENERAL SPECIFICATION



#### CERTIFICATION

Produced under a quality management system - ISO 9001:2008. Conforms to BS 2767-10.



#### GUARANTEE

2 year guarantee from date of purchase against manufacturing defects.



#### COLOUR

Finished in polished chrome.



#### CONNECTIONS

Compression or screwed iron.



#### OPERATING PRESSURES

Tested to a maximum pressure of 10 bar.



#### OPERATING TEMPERATURE

Maximum 120°C.



#### DELIVERY

2 - 5 working days.

For more general information, please see page 242.

DIMENSIONS

Handwheel

15mm & 1/2" Angle

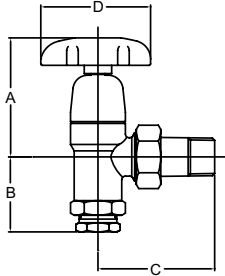

15mm & 1/2" Straight (for vertical mounting)

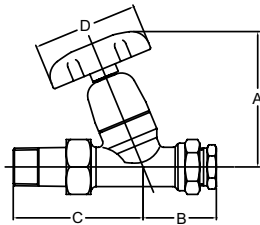

15mm & 1/2" Straight (for horizontal mounting)

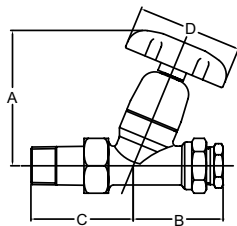

Model	A	B	C	D
	(mm)	(mm)	(mm)	(mm)
15mm & 1/2" Angle	65.0	41.0	55.0	60.0
15mm & 1/2" Straight (Vert)	74.0	40.0	71.0	60.0
15mm & 1/2" Straight (Horiz)	74.0	49.0	56.0	60.0

Lockshield

15mm & 1/2" Angle

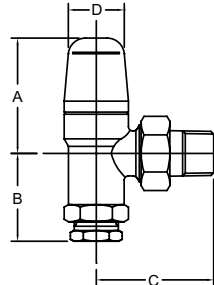

15mm & 1/2" Straight (for vertical mounting)

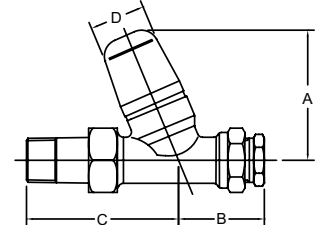

15mm & 1/2" Straight (for horizontal mounting)

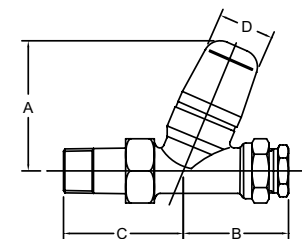

Model	A	B	C	D
	(mm)	(mm)	(mm)	(mm)
15mm & 1/2" Angle	54.0	41.0	55.0	26.0
15mm & 1/2" Straight (Vert)	61.0	40.0	71.0	26.0
15mm & 1/2" Straight (Horiz)	61.0	49.0	56.0	26.0

NB: All measurements are nominal.



DEC15HSHC



DEC15LAC

Description	Metal Finish	Order Code	Minimum Order Qty
15mm & 1/2" Angle Handwheel	Polished Chrome	DEC15HAC	1
15mm & 1/2" Angle Lockshield	Polished Chrome	DEC15LAC	1
15mm & 1/2" Straight Handwheel (for Vertical Mounting)	Polished Chrome	DEC15HSVC	1
15mm & 1/2" Straight Handwheel (for Horizontal Mounting)	Polished Chrome	DEC15HSHC	1
15mm & 1/2" Straight Lockshield (for Vertical Mounting)	Polished Chrome	DEC15LSVC	1
15mm & 1/2" Straight Lockshield (for Horizontal Mounting)	Polished Chrome	DEC15LSHC	1